



## angle joints

### DIN 71802 form CS long version with threaded pin

#### DIN 71802 form CS long version with threaded pin and safety clips

order example: angle joints DIN 71802 CS 10 - M 6, ball cups with size A = 37 mm

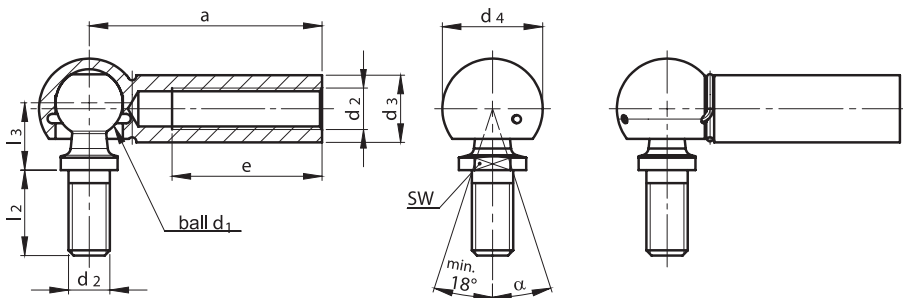

#### materials

##### ball cups

- steel with a minimum tensile strength of  $R_m$  500 N/mm<sup>2</sup>
- stainless steel 1.4305
- stainless steel 1.4571

##### Kugelzapfen

- steel with a minimum tensile strength of  $R_m$  600 N/mm<sup>2</sup>; ball hardened, degree of hardness at least 52 HRC or 550 HV 30, depth of hardening at least 1 mm
- stainless steel 1.4305
- stainless steel 1.4571

#### surface

- unplated
- zinc plated

ball $d_1$ h9	thread $d_2$	a $\pm 0,3$	$d_3$ $\pm 0,5$	$d_4$ $\pm 0,5$	e min.	$l_2$ $\pm 0,3$	$l_3$ $\pm 0,3$	SW h14	$\alpha$	weight approx. kg per 1000 pcs.
8	M 5	35	8	12,8	19,5	10,2	9,0	7	-	17,4
10	M 6	37 40	10	14,8	25,0 27,0	12,5	11,0	8	10°	30,3 31,9
13	M 8	45	13	19,3	29,0	16,5	13,0	11	15°	61,9
16	M 10	45 52	16	24,0	25,5 30,5	20,0	16,0	13	15°	106,5 114,1
16	M 12	45 52	16	24,0	25,5 30,5	20,0	16,0	13	15°	109,6 116,5
19	M 14 x 1,5 M 14 M 16	70	22	30,0	44,0	28,0	20,0	16	15°	260,0

\*tap drill size +0,15

Angle joints with hexagon nut DIN 934 loose, or mounted if requested.

#### optional features

- left-hand threaded ball cups; indication by LH; e.g. CS 16 - M 10 LH, size A = 45 mm
- easy moving version; indication by L; e.g. CSL 13 - M 8, size A = 45 mm
- ball cups hardened; indication by hardened; e.g. CS 10 - M 6 hardened, size A = 45 mm
- further special options available on request

