



angle joints DIN 71802 form C / CS with threaded pin

DIN 71802 form C with threaded pin without safety clips

order example: angle joints DIN 71802 C 8 - M 5

DIN 71802 form CS with threaded pin and safety clips

order example: angle joints DIN 71802 CS 16 - M 10

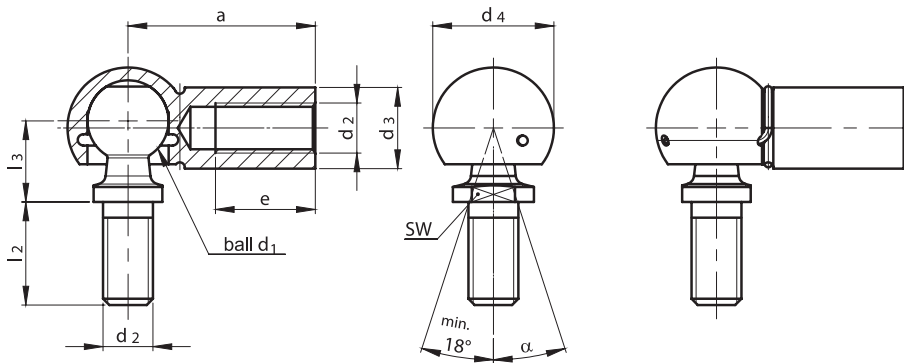

materials

ball cups

- steel with a minimum tensile strength of R_m 500 N/mm²
- stainless steel 1.4305
- stainless steel 1.4571

ball pins

- steel with a minimum tensile strength of R_m 600 N/mm²; ball hardened, degree of hardness at least 52 HRC or 550 HV 30, depth of hardening at least 1 mm
- stainless steel 1.4305
- stainless steel 1.4571

surface

- unplated
- zinc plated

ball d ₁ h9	thread d ₂	a ±0,3	d ₃ ±0,5	d ₄ ±0,5	e min.	l ₂ ±0,3	l ₃ ±0,3	SW h14	α	weight approx. kg per 1000 pcs.
6	M 4	22	7	10,6	10,2	8,0	8,5	5	-	9,8 (only form C)
8	M 5	22	8	12,8	10,2	10,2	9,0	7	10°	15,2
10	M 6	25	10	14,8	11,5	12,5	11,0	8	15°	25,2
13	M 8	30	13	19,3	14,0	16,5	13,0	11	15°	53,1
16	M 10 M 12	35	16	24,0	15,5	20,0	16,0	13	15°	103,8
19	M 14 x 1,5 M 14 M 16	45	22	30,0	21,5	28,0	20,0	16	15°	220,9

Angle joints with hexagon nut DIN 934 loose, or mounted if requested.

optional features

- left-hand threaded ball cups; indication by LH; e.g. CS 16 - M 10 LH
- easy moving version; indication by L; e.g. CSL 13 - M 8
- ball cups hardened; indication by hardened; e.g. CS 10 - M 6 hardened
- further special options available on request

