

## clevis

### DIN 71752 form G steel version (G 18 - G 50)

#### DIN 71752 form G steel version

order example: clevis DIN 71752 G 25 x 50 - M 24

Our clevises are also in accordance with DIN ISO 8140 except the chamfer point.

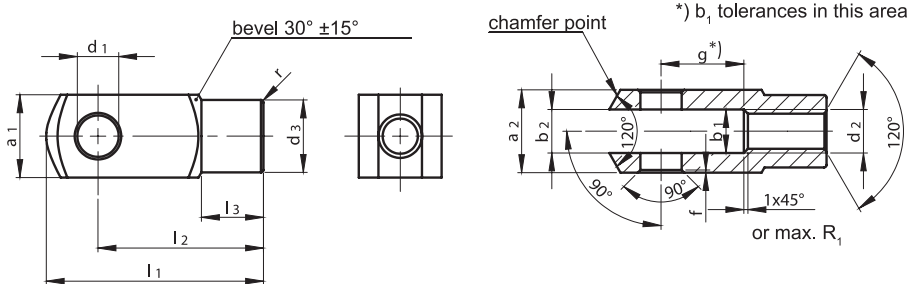

#### materials

- free-cutting steel 11SMnPb30+C or at the choice of the manufacturer
- stainless steel 1.4305
- stainless steel 1.4571 / 1.4404

#### surface

- unplated
- zinc plated

type size	d <sub>1</sub> H9	g ±0,5	a <sub>1</sub> <sup>1)</sup>	a <sub>2</sub> <sup>1)</sup> +0,30 -0,16	b <sub>1</sub> B13	b <sub>2</sub>	d <sub>2</sub>	d <sub>3</sub> ±0,3	f ±0,2	l <sub>1</sub> ±0,5	l <sub>2</sub>	l <sub>3</sub> ±0,2	r <sup>2)</sup>	weight approx. kg per piece
G 18 x 36	18	36	36	18			M 18	30	1,0	94	72	27	1,5	0,39
G 18 x 36 FG	18	36	36	18			M 18 x 1,5	30	1,0	94	72	27	1,5	0,39
G 20 x 40	20	40	40	20			M 20	34	1,0	105	80	30	1,5	0,55
G 20 x 40 FG	20	40	40	20			M 20 x 1,5	34	1,0	105	80	30	1,5	0,55
G 20 x 80	20	80	40	20			M 20	34	1,0	145	120	30	1,5	0,80
G 20 x 80 FG	20	80	40	20			M 20 x 1,5	34	1,0	145	120	30	1,5	0,80
G 25 x 50	25	50	50	25			M 24	42	1,5	132	100	36	1,5	1,10
G 25 x 50 FG	25	50	50	25			M 24 x 2	42	1,5	132	100	36	1,5	1,10
G 28 x 56	28	56	55	28			M 27	48	1,5	148	112	40	2,0	1,50
G 28 x 56 FG	28	56	55	28			M 27 x 2	48	1,5	148	112	40	2,0	1,50
G 30 x 54 FG	30	54	55	30			M 27 x 2	48	1,5	148	110	40	2,0	1,44
G 30 x 60	30	60	60	30	+0,7 +0,15		M 30	52	1,5	160	120	42	2,0	1,97
G 30 x 60 FG	30	60	60	30			M 30 x 2	52	1,5	160	120	42	2,0	1,97
G 35 x 54 FG	35	54	70	35			M 36 x 2	60	2,0	188	144	54	3,0	2,93
G 35 x 72	35	72	70	35			M 36	60	2,0	188	144	54	3,0	2,93
G 35 x 72 FG	35	72	70	35			M 36 x 2	60	2,0	188	144	54	3,0	2,93
G 36 x 72	35	72	70	36			M 36	60	2,0	188	144	54	3,0	2,93
G 36 x 72 FG	35	72	70	36			M 36 x 2	60	2,0	188	144	54	3,0	2,93
G 40 x 84 FG	40	84	85	40			M 42 x 2	70	3,0	232	168	63,5	5,0	5,34
G 42 x 84	42	84	85	42			M 42	70	3,0	232	168	63,5	5,0	5,34
G 42 x 84 FG	42	84	85	42			M 42 x 2	70	3,0	232	168	63,5	5,0	5,34
G 50 x 96	50	96	96	50			M 48	82	3,0	265	192	73	5,0	7,86
G 50 x 96 FG	50	96	96	50			M 48 x 2	82	3,0	265	192	73	5,0	7,86

remarks:

<sup>1)</sup> dimensional tolerance half-finished product h11 acc. DIN 178

<sup>2)</sup> radius or 45° chamfer (at the choice of the manufacturer)

FG = fine-pitch thread

#### optional features

- left-hand thread on demand; indication by LH; e.g. G 30 x 60 - M 30 LH
- further special options available on request

